

CONNECTING SOLAR PANELS

2400 RIGID KIT

200 watt panel

**ONLY FOR POINT ZERO ENERGY SOLAR PANELS.
DO NOT USE this wiring diagram with any other solar panels.**

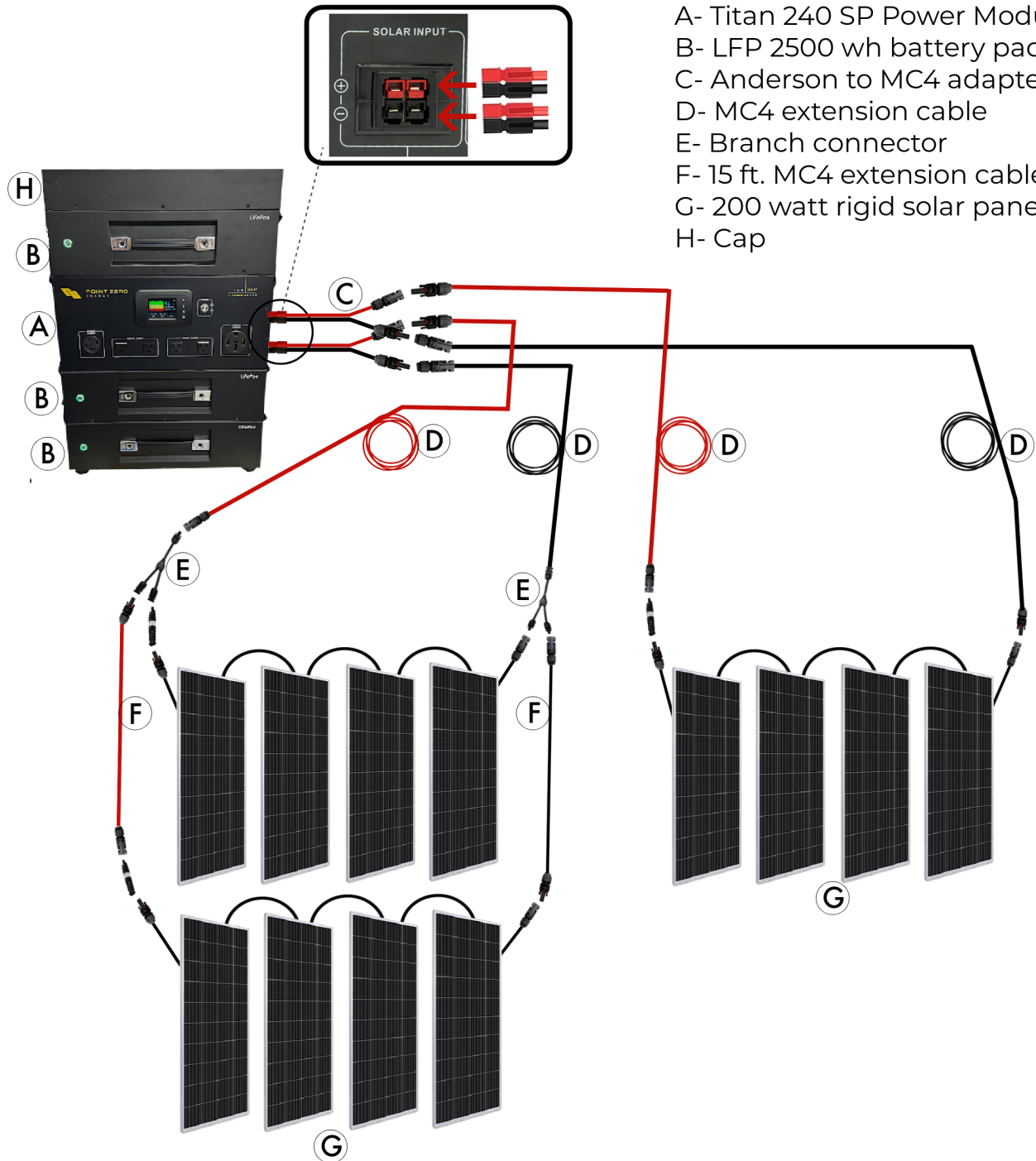

- A- Titan 240 SP Power Module
- B- LFP 2500 wh battery pack
- C- Anderson to MC4 adapter
- D- MC4 extension cable
- E- Branch connector
- F- 15 ft. MC4 extension cable
- G- 200 watt rigid solar panels
- H- Cap